

**BYLAW 23-036
OF
LAC LA BICHE COUNTY**

A BYLAW OF LAC LA BICHE COUNTY IN THE PROVINCE OF ALBERTA TO AMEND BYLAW 22-012, AS AMENDED, BEING THE MUNICIPAL DEVELOPMENT PLAN OF LAC LA BICHE COUNTY.

WHEREAS Council adopted Bylaw 22-012 to be used as the Lac La Biche County Municipal Development Plan; and

WHEREAS it is deemed expedient to amend Bylaw 22-012, as amended, as set out in Section 692 of the *Municipal Government Act*, R.S.A. 2000, Chapter M 26, as amended;

NOW THEREFORE under the authority and subject to the provisions of the *Municipal Government Act*, and by virtue of all other powers enabling it, the Council of Lac La Biche County, duly assembled, enacts as follows:

Bylaw 22-012 Amendments

- 1 That Bylaw 22-012 being the Municipal Development Plan is amended as follows:
 - (a) Schedule "A" Map 3, Future Land Use – Hamlet of Lac La Biche, is amended such that Lot 1, Plan 9825914 containing 0.543 Ha (1.34 Ac) in size more or less, be redesignated from Residential to Commercial as shown on Schedule 'A' of this Bylaw.

Severability

- 2 Each provision of this Bylaw is independent of all other provisions. If any such provision is declared invalid by a court of competent jurisdiction, all other provisions of this Bylaw will remain valid and enforceable.

Effective Date

- 3 This bylaw shall come into effect upon passing of the third reading.

THAT BYLAW 23-036 BE GIVEN FIRST READING THIS 14TH DAY OF NOVEMBER, 2023.

THAT BYLAW 23-036 BE GIVEN SECOND READING THIS 5TH DAY OF DECEMBER, 2023.

THAT BYLAW 23-036 BE GIVEN THIRD READING THIS 5TH DAY OF DECEMBER, 2023.

"Original Signed"

Mayor

"Original Signed"

Chief Administrative Officer

Schedule 'A'

Bylaw 23-036

Lot 1, Plan 9825914

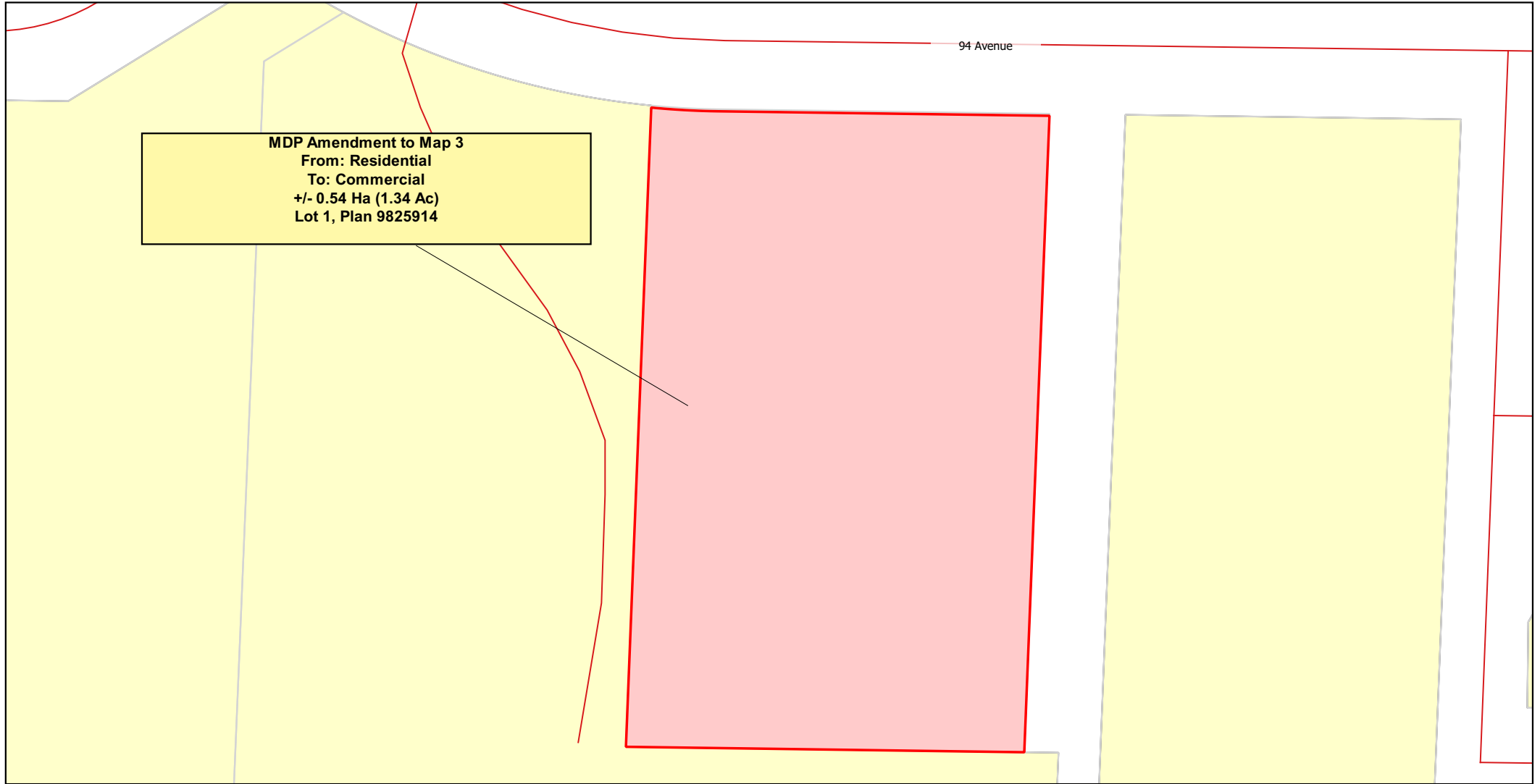

MDP Amendment to Map 3
From: Residential
To: Commercial
+/- 0.54 Ha (1.34 Ac)
Lot 1, Plan 9825914

94 Avenue

Subject Property
 Residential
 Commercial

Map Produced: October 25, 2023

Projection: UTM12 NAD83



Lac La Biche County makes no representation or warranties regarding the information contained in this document, including, without limitation, whether said information is accurate or complete. Persons using this document do so solely at their own risk, and Lac La Biche County shall have no liability to such persons for any loss or damage whatsoever. This document shall not be copied or distributed to any person without the express written consent of Lac La Biche County.

Base Map compiled from the Provincial Title Mapping Digital Base. Spatial Data Warehouse Ltd., November 2022. © 2023 Lac La Biche County. All Rights Reserved.