

**BYLAW 18-026  
OF  
LAC LA BICHE COUNTY**

---

BEING A BYLAW OF LAC LA BICHE COUNTY IN THE PROVINCE OF ALBERTA, TO AMEND BYLAW 17-004, BEING THE LAND USE BYLAW OF THE LAC LA BICHE COUNTY.

---

**WHEREAS** Council has adopted the Lac La Biche County Bylaw 17-004 to be used as the Lac La Biche County Land Use Bylaw; and

**WHEREAS** it is deemed expedient to amend Bylaw 17-004 as set out in Section 692 of the *Municipal Government Act*, S.A. 2000, Chapter M-26, as amended.

**NOW THEREFORE** under the authority and subject to the provisions of the *Municipal Government Act*, and by virtue of all other powers enabling it, the Council of Lac La Biche County hereby assembled enacts as follows:

1. Schedule "A" of Land Use Bylaw 17-004 be amended such Block B2, Plan 1041HW containing +/- 1.919 Ha (4.73 acres) in size more or less, as shown on attached Schedule 'A' be rezoned from Medium Density Residential District (MDR) to Low Density Residential District (LDR).
  
2. This Bylaw shall come into effect upon passing of third reading.

**MOTION BY COUNCILLOR COTE THAT BYLAW 18-026 BE GIVEN FIRST READING THIS 11<sup>th</sup> DAY OF SEPTEMBER, 2018.**

"Original Signed"  
\_\_\_\_\_  
Mayor

"Original Signed"  
\_\_\_\_\_  
Chief Administrative Officer

**MOTION BY COUNCILLOR TKACHUK THAT BYLAW 18-026 BE GIVEN SECOND READING THIS 2<sup>nd</sup> DAY OF OCTOBER, 2018.**

**MOTION BY COUNCILLOR STEDMAN THAT BYLAW 18-026 BE GIVEN THIRD READING THIS 2<sup>nd</sup> DAY OF OCTOBER, 2018.**

"Original Signed"  
\_\_\_\_\_  
Mayor

"Original Signed"  
\_\_\_\_\_  
Chief Administrative Officer

# SCHEDULE A Bylaw No. 18-026



**From: Medium Density Residential District (MDR)**  
**To: Low Density Residential District (LDR)**  
**Block B2, Plan 1041HW**  
**+/- 1.919 Ha (4.73 acres)**

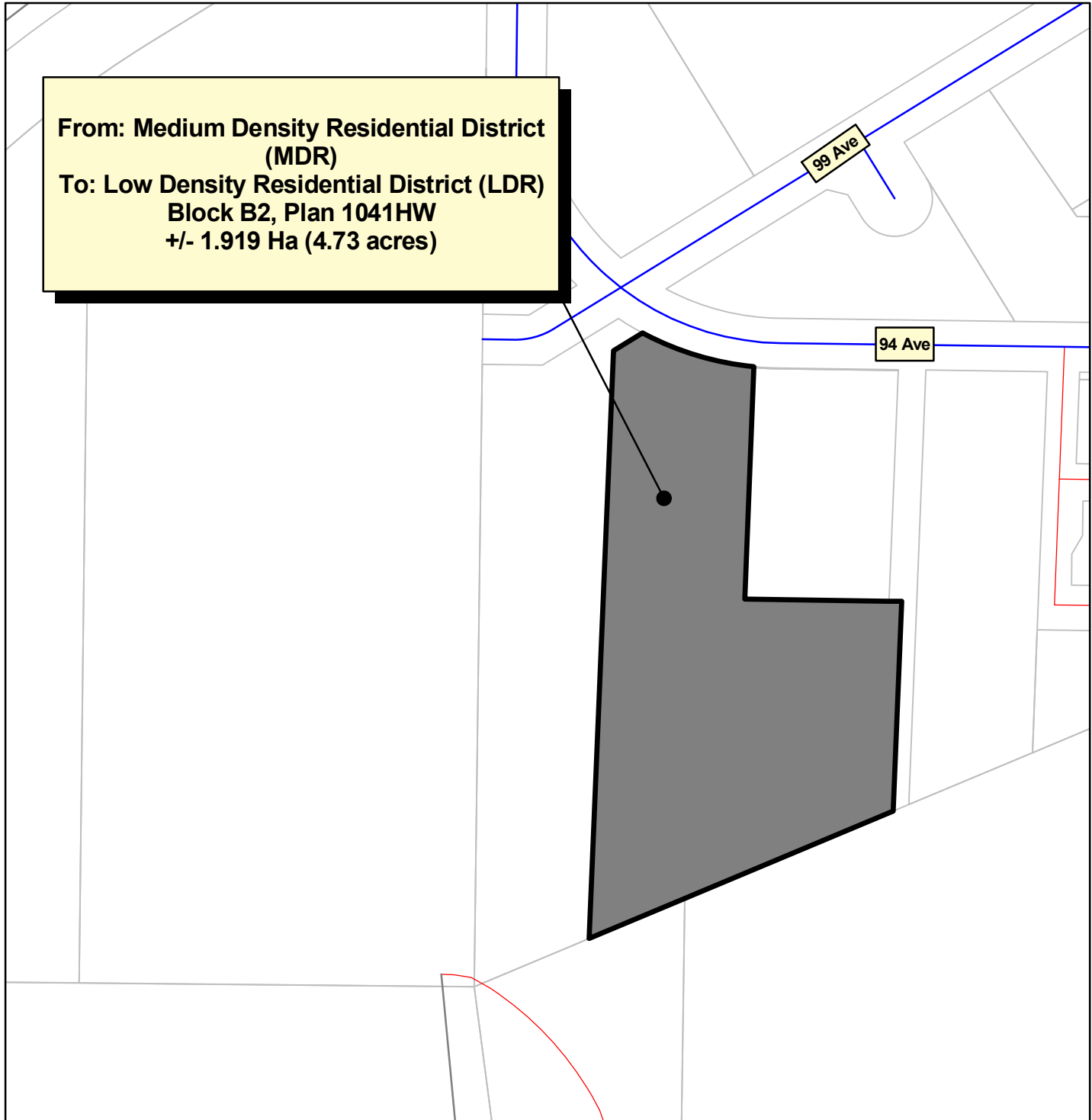

Scale 1:7500

	Subject Property		Gravel Road
	Cadastre		Oiled Road
	Hydro Line		Paved Road
	Waterbody		Paved Highway
			Gravel Highway

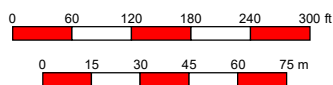

Map Produced: September 4, 2018      Projection: UTM12 NAD83

Lac La Biche County makes no representation or warranties regarding the information contained in this document, including, without limitation, whether said information is accurate or complete. Persons using this document do so solely at their own risk, and Lac La Biche County shall have no liability to such persons for any loss or damage whatsoever.

This document shall not be copied or distributed to any person without the express written consent of Lac La Biche County

Base Map compiled from the Provincial Title Mapping Digital Base. Spatial Data Warehouse Ltd., May 30, 2016

© 2016 Lac La Biche County. All Rights Reserved.