

**BYLAW 21-014
OF
LAC LA BICHE COUNTY**

A BYLAW OF LAC LA BICHE COUNTY IN THE PROVINCE OF ALBERTA TO ALLOW FOR AN ENCROACHMENT WITH PART OF LOT R1, BLOCK 1, PLAN 7720980.

WHEREAS section 676(1) of the Municipal Government Act, R.S.A. 2000, as amended, authorizes a municipality to pass a bylaw with respect to the use of an environmental reserve;

AND WHEREAS section C1.13 of Bylaw 17-004, as amended, being the Land Use Bylaw of Lac La Biche County, prohibits encroachments on environmental reserve land;

AND WHEREAS it is deemed expedient to pass a bylaw pursuant to section 676 of the Act and to amend Bylaw 17-004 for the purpose of allowing an encroachment within part of Lot R1, Block 1, Plan 7720980;

NOW THEREFORE under the authority and subject to the provisions of the *Municipal Government Act*, and by virtue of all other powers enabling it, the Council of Lac La Biche County, duly assembled, enacts as follows:

Bylaw pursuant to section 676 of the Act

- 1 An encroachment is permitted within that portion of Lot R1, Block 1, Plan 7720980, as identified on attached Schedule A, for the construction of a retaining wall.

Bylaw 17-004 Amendments

- 2 That section C1.13 of Bylaw 17-004, being the Land Use Bylaw, is amended by inserting Section C1.13(4) as follows:

“Notwithstanding Section C1.13(3) and in accordance with Section C1.13(2)(a), an encroachment is permitted within a portion of Lot R1, Block 1, Plan 7720980 adjacent to parcels: Lot 11, Block 6, Plan 7720980 and Lot 12, Block 6, Plan 7720980.”

Severability

- 3 Each provision of this Bylaw is independent of all other provisions. If any such provision is declared invalid by a court of competent jurisdiction, all other provisions of this Bylaw will remain valid and enforceable.

Effective Date

- 4 This bylaw shall come into effect upon passing of the third reading.

THAT BYLAW 21-014 BE GIVEN FIRST READING THIS 27th DAY OF APRIL, 2021.

"Original Signed"

Mayor

"Original Signed"

Chief Administrative Officer

THAT BYLAW 21-014 BE GIVEN SECOND READING THIS 25TH DAY OF MAY, 2021.

THAT BYLAW 21-014 BE GIVEN THIRD READING THIS THIS 25TH DAY OF MAY, 2021.

"Original Signed"

Mayor

"Original Signed"

Chief Administrative Officer

Schedule 'A'

BYLAW 21-014

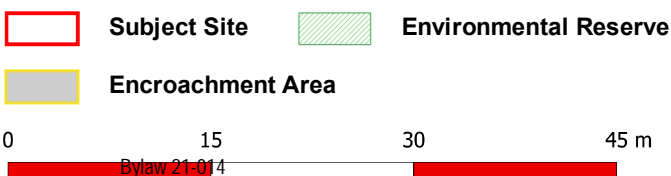
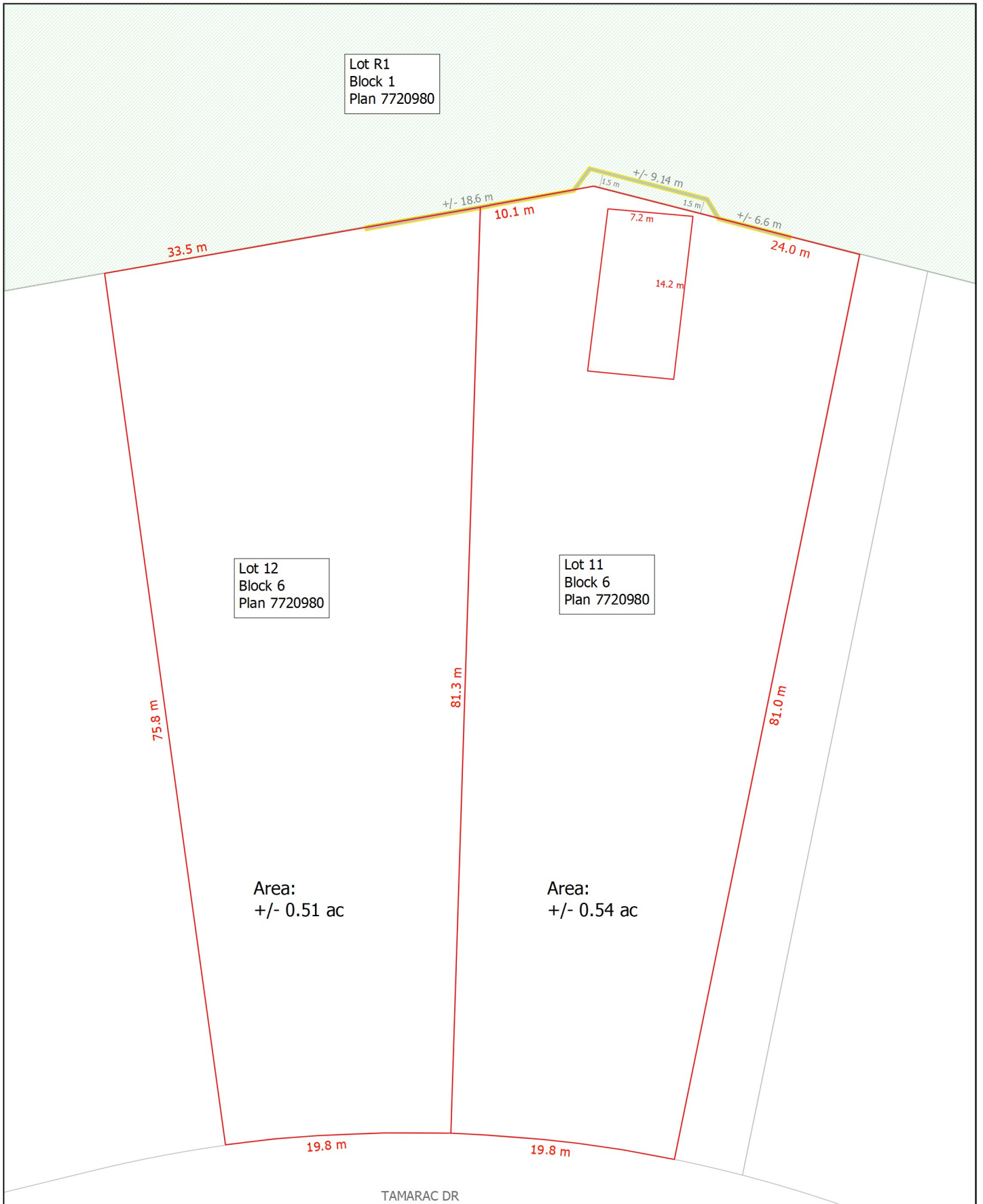

Map Produced: April 20, 2021

Projection: UTM12 NAD83

Lac La Biche County makes no representation or warranties regarding the information contained in this document, including, without limitation, whether said information is accurate or complete. Persons using this document do so solely at their own risk, and Lac La Biche County shall have no liability to such persons for any loss or damage whatsoever. This document shall not be copied or distributed to any person without the express written consent of Lac La Biche County.

Base Map compiled from the Provincial Title Mapping Digital Base. Spatial Data Warehouse Ltd., November 2020. © 2021 Lac La Biche County. All Rights Reserved.