

**BYLAW 22-011  
OF  
LAC LA BICHE COUNTY**

---

A BYLAW OF LAC LA BICHE COUNTY IN THE PROVINCE OF ALBERTA TO AMEND BYLAW 17-004, AS AMENDED, BEING THE LAND USE BYLAW OF LAC LA BICHE COUNTY.

---

**WHEREAS** Council adopted Lac La Biche County Bylaw 17-004 to be used as the Lac La Biche County Land Use Bylaw; and

**WHEREAS** it is deemed expedient to amend Bylaw 17-004, as amended, as set out in Section 692 of the *Municipal Government Act*, R.S.A. 2000, Chapter M-26, as amended;

**NOW THEREFORE** under the authority and subject to the provisions of the *Municipal Government Act*, and by virtue of all other powers enabling it, the Council of Lac La Biche County, duly assembled, enacts as follows:

**Bylaw 17-004 Amendments**

1 That Bylaw 17-004, as amended, being the Land Use Bylaw is amended as follows:

- (a) Schedule "A" is amended such that part of Lot 1, Block 1, Plan 0425494 (Pt. of SL-71-67-13-W4M) containing 0.652 Ha (1.61 Ac) in size more or less, as shown on Schedule 'A' of this Bylaw is rezoned from Agricultural District (AG) to Estate Small Lot Residential District 2 (ES2).

**Severability**

2 Each provision of this Bylaw is independent of all other provisions. If any such provision is declared invalid by a court of competent jurisdiction, all other provisions of this Bylaw will remain valid and enforceable.

**Effective Date**

3 This Bylaw shall come into effect upon passing of the third reading.

**THAT BYLAW 22-011 BE GIVEN FIRST READING THIS 5<sup>TH</sup> DAY OF APRIL, 2022.**

"Original Signed"

\_\_\_\_\_  
Mayor

"Original Signed"

\_\_\_\_\_  
Chief Administrative Officer

**THAT BYLAW 22-011 BE GIVEN SECOND READING THIS 26<sup>th</sup> DAY OF APRIL, 2022.**

**THAT BYLAW 22-011 BE GIVEN THIRD READING THIS THIS 26<sup>th</sup> DAY OF APRIL, 2022.**

"Original Signed"

---

Mayor

"Original Signed"

---

Chief Administrative Officer

# Schedule 'A'

## Bylaw 22-011

Part of Lot 1, Block 1, Plan 0425494 (Pt. SL-71-67-13-W4M)



**From: Agriculture District (AG)**  
**To: Estate Small Lot Residential District 2 (ES2)**  
 +/- 0.652 Ha (1.61 Ac.)  
 Part of Lot 1, Block 1, Plan 0425494 (Pt. SL-71-67-13-W4M)

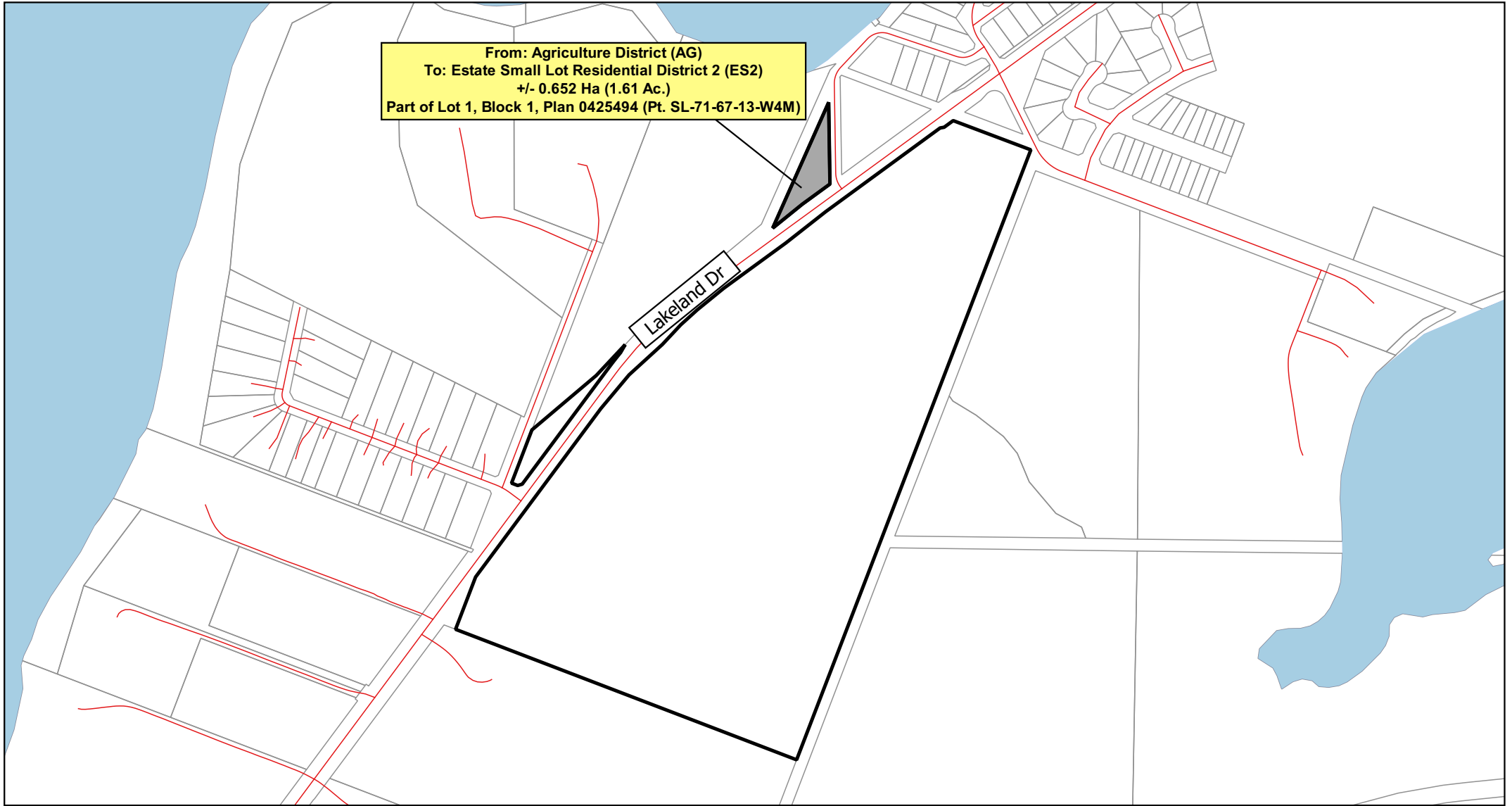

 Proposed Rezoning

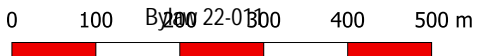

Map Produced: March 15, 2022

Projection: UTM12 NAD83

Lac La Biche County makes no representation or warranties regarding the information contained in this document, including, without limitation, whether said information is accurate or complete. Persons using this document do so solely at their own risk, and Lac La Biche County shall have no liability to such persons for any loss or damage whatsoever. This document shall not be copied or distributed to any person without the express written consent of Lac La Biche County.

Base Map compiled from the Provincial Title Mapping Digital Base.  
 Spatial Data Warehouse Ltd., November 2021. © 2022 Lac La Biche County. All Rights Reserved.