

# YOUR COUNTY IN TOUCH

Issue No. 154 August 2024



## Citizens Satisfaction Survey results

We would like to thank everyone who participated in our 2024 Citizens Satisfaction Survey. This survey tracks how our programs and services are meeting our residents' needs, and which service categories they consider to be most important to them.

We're pleased to report that 87 per cent of survey respondents rated living in Lac La Biche County as either good or very good. The full survey results can be found online at [laclabichecounty.com](http://laclabichecounty.com).

### Highlights



Some areas where ratings have improved since 2022:

- Road maintenance
- Program access and registration



Some areas where ratings have gone down since 2022:

- Transparent decision-making
- Environmental sensitivity

Our local fire department, Lac La Biche County Fire Rescue, is once again at the top of the rankings — 86 per cent of survey respondents say it's important, and 84 per cent are satisfied with our firefighters' hard work.



## Cultivating economic growth & agri-tourism

We're planting the seeds of a bountiful agri-tourism harvest, and all community members are invited to reap some of what we're sowing.

We are launching an agri-tourism workshop series this fall, to bring local producers, retailers and partners together and grow bold new ideas for our region.

### What is agri-tourism?

Agri-tourism is any type of tourism that connects to agriculture. Think farm tours, farmers markets, you-pick harvesting, farm-to-table dining and more. Agri-tourism can also include unique accommodations like guest ranches, or recreational activities like hayrides.

### Think outside the shelterbelt!

Even if your property doesn't strike you as an agri-tourism attraction right now, don't miss this opportunity to network and learn. Agri-tourism is all about diversifying and growing new revenue streams. There are opportunities for everyone to add new products, add value to existing products, and reach new customers.

### WORKSHOP SERIES KICK-OFF >>

**Tuesday, Aug. 27 from 4-7 pm at McArthur Place.**

- Meet the project management team and learn about what's in it for you.
- Network with agri-tourism operators, hear their success stories, and get the inside track on potential partnerships.
- Register for upcoming workshops.
- Ask us anything you want to know about starting or growing a local agri-tourism business!

Future workshop topics include value-added agriculture, cluster development (working together to build capacity and tap into new markets), connecting local ingredients with local vendors and restaurants, and more. At the end, a wealth of locally sourced knowledge will be available to all current and potential agri-tourism operators.

*This project is made possible with funding from the Government of Alberta's Small Community Opportunity Program.*

## New Aquatics Facility: A deep dive into a design-build

Construction of our new Aquatics Facility is well underway, and as part of the “design as you build” process we’ve adopted for maximum flexibility, Council has been discussing the different features that can be included in the facility to make it as dynamic and enjoyable a place as possible.

Council recently voted to include a barrel sauna in the facility’s outdoor space, to complement the outdoor hot tub and fireside seating area and give guests a spa-like experience.

Inside, waterslides and play features like geysers are still under discussion. Here’s what we know so far:

- The main waterslide will have programmable lights, so users can slide through an immersive light show.
- The main slide will also have a rider timing system, for friends who like to compete.
- The leisure pool will have interactive play features like geysers and waterspouts, and an adjoining lazy river for those who like nothing better than a relaxing float.

For regular project updates, visit [boldcentreaquatics.com](http://boldcentreaquatics.com). Due to the project’s design-build process, details are subject to change.

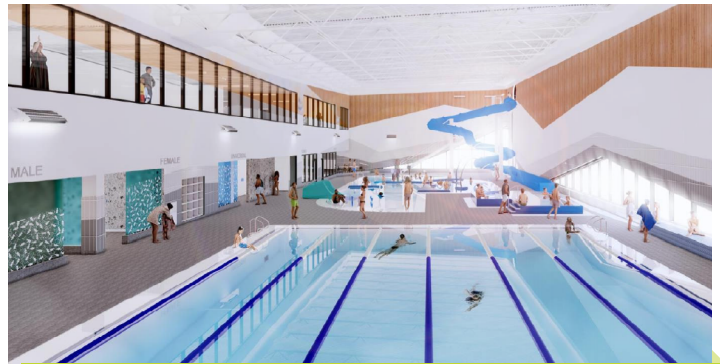

**Above:** A rendering of the interior of the new Aquatics Facility, looking across the 25-metre lap pool towards the leisure pool and waterslide.

**Below:** A rendering of the expanded outdoor space, where Council has asked to include a barrel sauna.

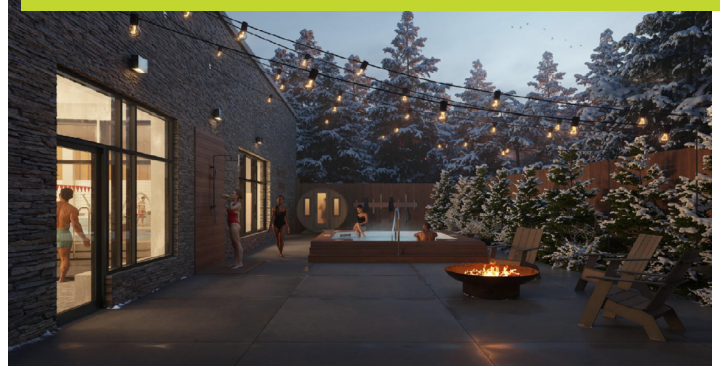

## Efficiency Review shows organization strength, opportunities

Lac La Biche County recently completed a deep dive into our own operations, as part of our ongoing mission to provide value for taxpayers’ money.

We typically provide very high service levels, but our next steps include deciding on service standards, so County employees, Council and our residents are all on the same page about what we do and don’t provide. This information will also help Council make decisions in line with what people need from us.

**A public summary of our Efficiency Review Report will be available online at [laclabichcounty.com](http://laclabichcounty.com).**



Some areas where greater efficiency can be found in our organization, as noted in the Efficiency Review Report, include:

- **Governance:** Council and staff members have different roles, and it’s important to stay in our respective lanes.
- **Technology:** There are opportunities to modernize the way we do things, making our services more accessible and convenient.
- **Communication:** There’s a need for enhanced communication between us and the public, as well as internally between our different departments and divisions.

In the months ahead, as we get to work on the report recommendations, we will be making changes to our organization to become more cost-effective in our program and service delivery.

# PLANNING & DEVELOPMENT SIMPLIFIED



## ON THE MAP

**DYK?** You can learn a surprising amount about your property, just by visiting our website.

We have a free online mapping system that allows anyone to see property zoning, water and sewer line networks, wetland locations and more in Lac La Biche County.

### To use the system:

1. Go to [laclabichedev.com/p/maps](http://laclabichedev.com/p/maps) and scroll to “County Mapping System.”
2. Click on “Login as guest” and agree to the system’s terms and conditions.
3. Use the sidebar to toggle layers and change map features.
4. Click on a specific property to see tax information and development permit history.

**Note:** Guest users cannot see personal information about property owners.

**I looked at my property and I spotted something that piqued my interest. How do I find out more?** Contact our Planning & Development team to learn more about how property and community features, like the presence of a wetland, impact your development options.

T: 780-623-1747

E: [planning.development@laclabichedev.com](mailto:planning.development@laclabichedev.com)

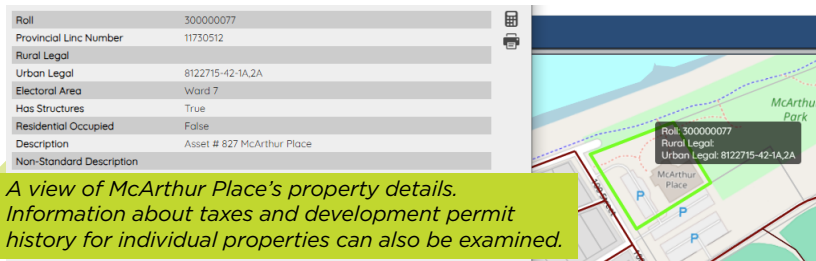

A view of McArthur Place’s property details. Information about taxes and development permit history for individual properties can also be examined.

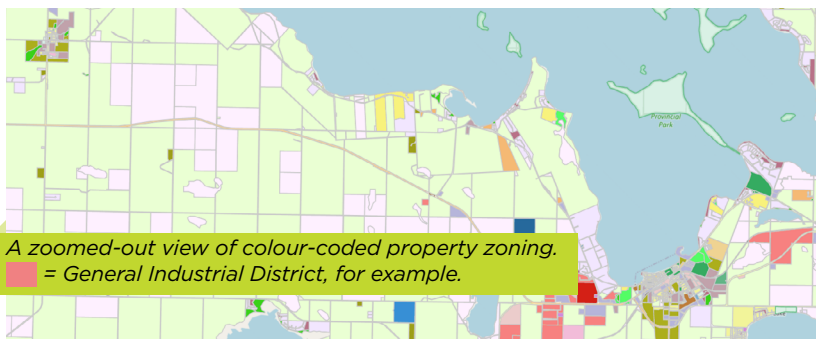

A zoomed-out view of colour-coded property zoning. = General Industrial District, for example.

# LET’S CONNECT

Community Event at the Bold Centre

The ultimate showcase of local community groups, non-profit organizations, sports leagues and more is coming up on Friday, Sept. 6 at the Bold Centre.

Join us from 5:30-8 pm for a free information fair, where you can learn who’s who, discover volunteer opportunities, register for activities on the spot, enjoy a free community BBQ and win great prizes.



To reserve a table for your group or organization at Let’s Connect, please contact Chenée Miller at [cheneemiller@laclabichedev.com](mailto:cheneemiller@laclabichedev.com).

Don’t miss this prime opportunity to tell your fellow community members who you are and what you do that helps make Lac La Biche County a great place to live, work and play!



## Dates to Remember

### August 16-18

Kikino Cultural Celebrations Days and Silver Birch Rodeo.

### Thursday, Aug. 22

Summer Outdoor Movie at Plamondon Festival Centre, showing "Ghostbusters: Frozen Empire." Gates open at 7:30 pm and the movie will start at dusk.

### August 23-24

Hylo Harvest Days.

### August 23-25

Heart Lake First Nation Pow Wow.

### Thursday, Aug. 29

Summer Outdoor Movie in McArthur Park, showing "Wonka." Gates open at 7:30 pm and the movie will start at dusk.

### Friday, Aug. 30

Farm to Table Dinner, sponsored by Plamondon Agricultural Society at Plamondon Festival Centre. Dinner at 6 pm, followed by mentalist entertainment. Tickets cost \$40 per person. Call 780-798-3478 by Aug. 26 for tickets.

**For more County and community events, visit the Events Calendar on [laclabichcounty.com](http://laclabichcounty.com).**

Your County in Touch is produced by Lac La Biche County and is available to every resident.

An electronic version of this newsletter is available. All you need to do is call (780) 623-1747 or provide your e-mail address to [intouch@laclabichcounty.com](mailto:intouch@laclabichcounty.com).

Use the same contact information for any address changes, additional copies or to unsubscribe.



**JOIN US ONLINE TO:**

- UPDATE ACCOUNTS
- REGISTER FOR PROGRAMS
- VIEW FACILITY SCHEDULES
- BUY OR MANAGE MEMBERSHIPS & GIFT CARDS

**NEW!**

# EARLY ONLINE REGISTRATION OPENS AUGUST 8!

For a easy online experience, activate or update your online account today!  
In Person/Phone Registration Opens: **August 15**