

- RESIDENTIAL DISTRICTS**
- Narrow Lot Single Detached Dwelling (NSD)
  - Medium Density Hamlet Residential (MDR)
  - Estate Small Lot Residential 1 (ES1)
  - Country Residential (CR)
  - Mobile Home Community (MHC)
  - Resort Recreational (RR)
  - Rural Residential Work/Live (RRW)
  - Low Density Residential (LDR)
  - High Density Hamlet Residential (HDR)
  - Estate Small Lot Residential 2 (ES2)
  - On-site Estate Residential 1 (OE1)
  - On-site Estate Residential 2 (OE2)
  - Restricted Residential Large Lot (RR)

- COMMERCIAL DISTRICTS**
- Central Commercial (CC)
  - Highway Commercial (HC)
  - Neighbourhood Commercial (NC)
  - Rural Commercial (RC)
  - Mixed Use Residential - Business (MREB)
  - Hamlet Commercial Business (HCB)
- PUBLIC SERVICES DISTRICTS**
- Urban Reserve (UR)
  - Public Institutional (PI)
  - Natural Area Protection (NAP)
  - Parks and Recreation (PR)

- INDUSTRIAL DISTRICTS**
- Light Industrial (LI)
  - Hamlet Light Industrial (HLI)
  - General Industrial (GI)
  - Heavy Industrial (HI)
  - Airport (A)
- DIRECT CONTROL DISTRICTS**
- Direct Control 1 (DC1)
  - Direct Control 2 (DC2)
  - Direct Control 3 (DC3)

- RESOURCES DISTRICTS**
- Agricultural (AG)
  - Crown Land (CL)

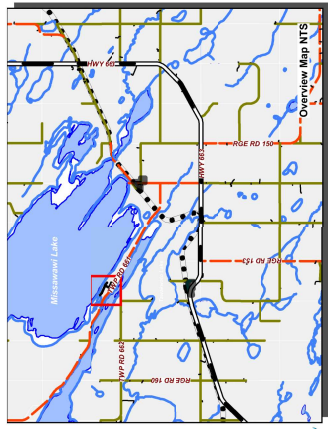

Scale 15,000

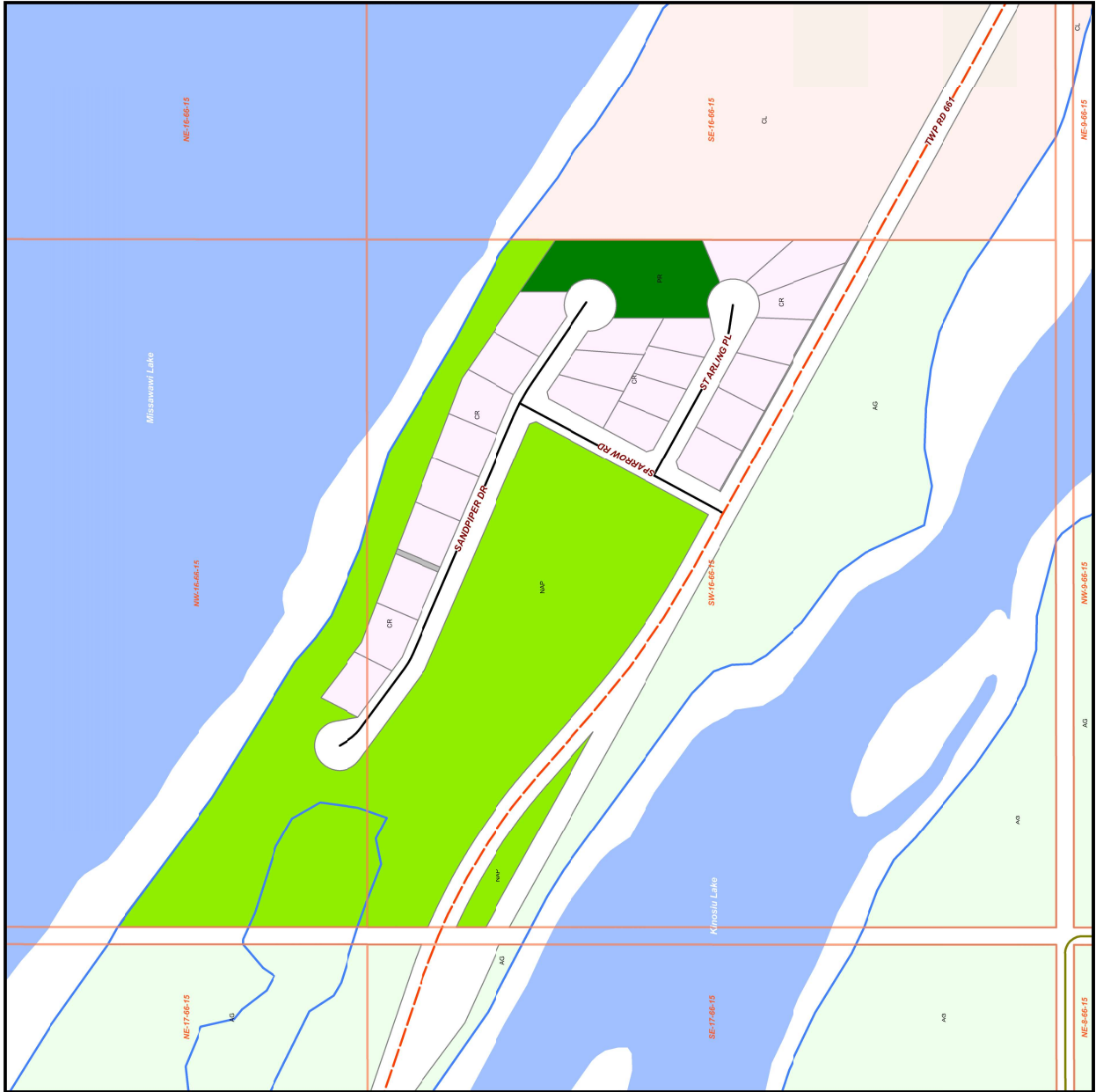

Map Sheet Updated: September 2017  
 Compiled from the Rural Cadastral Digital Base May 2017  
 Shaded Data Warehouses July 2017  
 All Rights Reserved.  
 Not to be copied in whole or in part.

<p><b>RESIDENTIAL DISTRICTS</b></p> <ul style="list-style-type: none"> <li>Narrow Lot Single Detached Dwelling (NSD)</li> <li>Medium Density Hamlet Residential (MDR)</li> <li>Estate Small Lot Residential 1 (ES1)</li> <li>Country Residential (CR)</li> <li>Mobile Home Community (MHC)</li> <li>Resort Recreational (RR)</li> <li>Rural Residential Work/Live (RRW)</li> </ul>	<ul style="list-style-type: none"> <li>Low Density Residential (LDR)</li> <li>High Density Hamlet Residential (HDR)</li> <li>Estate Small Lot Residential 2 (ES2)</li> <li>On-site Estate Residential 1 (OE1)</li> <li>On-site Estate Residential 2 (OE2)</li> <li>Restricted Residential Large Lot (RR)</li> </ul>
<p><b>COMMERCIAL DISTRICTS</b></p> <ul style="list-style-type: none"> <li>Central Commercial (CC)</li> <li>Highway Commercial (HC)</li> <li>Neighbourhood Commercial (NC)</li> <li>Rural Commercial (RC)</li> <li>Mixed Use Residential - Business (MRB)</li> <li>Hamlet Commercial Business (HC-B)</li> </ul>	<p><b>PUBLIC SERVICES DISTRICTS</b></p> <ul style="list-style-type: none"> <li>Urban Reserve (UR)</li> <li>Public Institutional (PI)</li> <li>Natural Area Protection (NAP)</li> <li>Parks and Recreation (PR)</li> </ul>
<p><b>INDUSTRIAL DISTRICTS</b></p> <ul style="list-style-type: none"> <li>Light Industrial (LI)</li> <li>Hamlet Light Industrial (HLI)</li> <li>General Industrial (GI)</li> <li>Heavy Industrial (HI)</li> <li>Airport (A)</li> </ul>	<p><b>DIRECT CONTROL DISTRICTS</b></p> <ul style="list-style-type: none"> <li>Direct Control 1 (DC1)</li> <li>Direct Control 2 (DC2)</li> <li>Direct Control 3 (DC3)</li> </ul>
<p><b>RESOURCES DISTRICTS</b></p> <ul style="list-style-type: none"> <li>Agricultural (AG)</li> <li>Crown Land (CL)</li> </ul>	

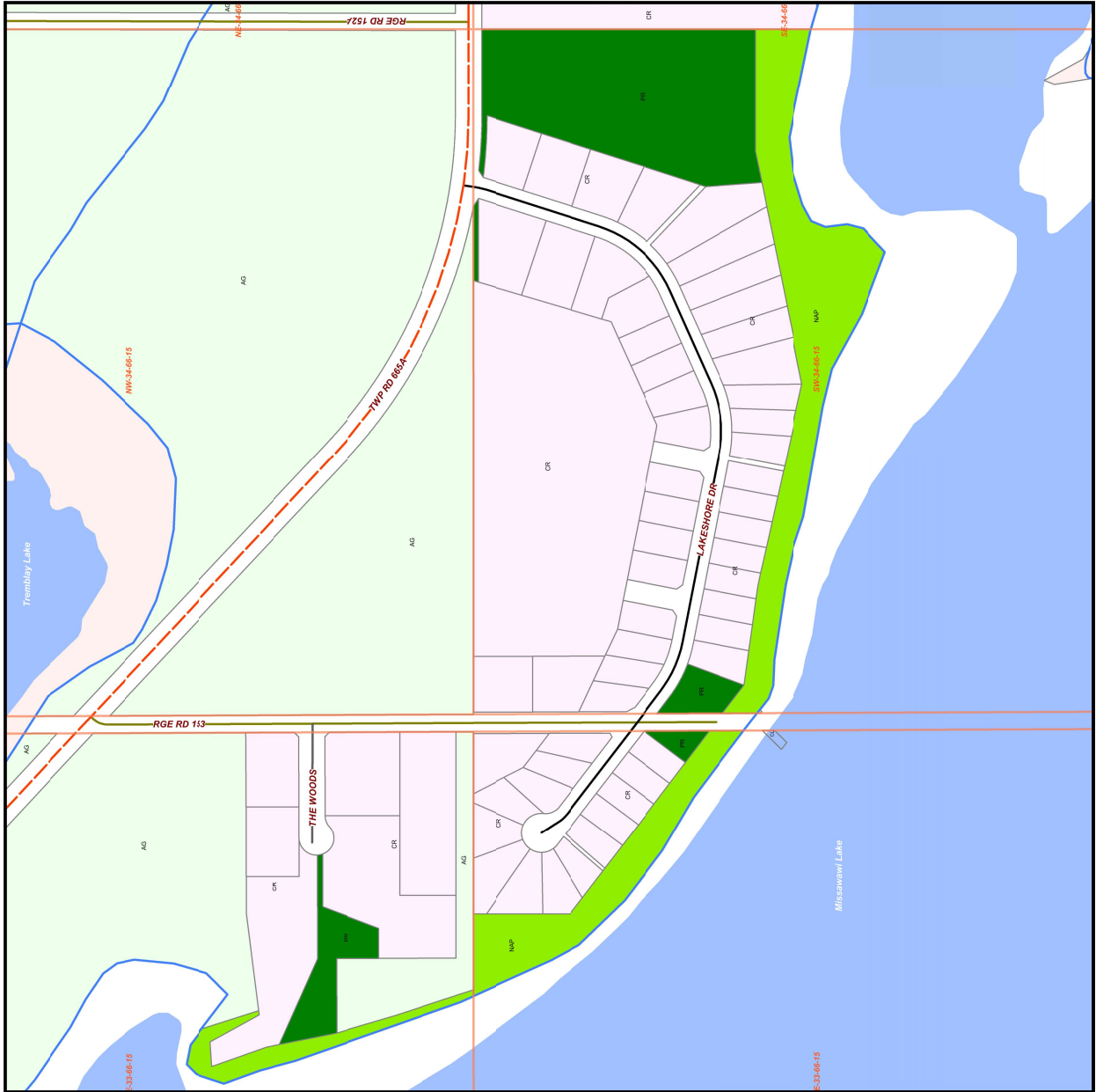

Scale 15,000



Map Sheet Updated: September 2017  
 Compiled from the Rural Cadastrial Digital Base May 2017  
 Shaded Data Warehouses Ltd.  
 All Rights Reserved.  
 Not to be copied in whole or in part.

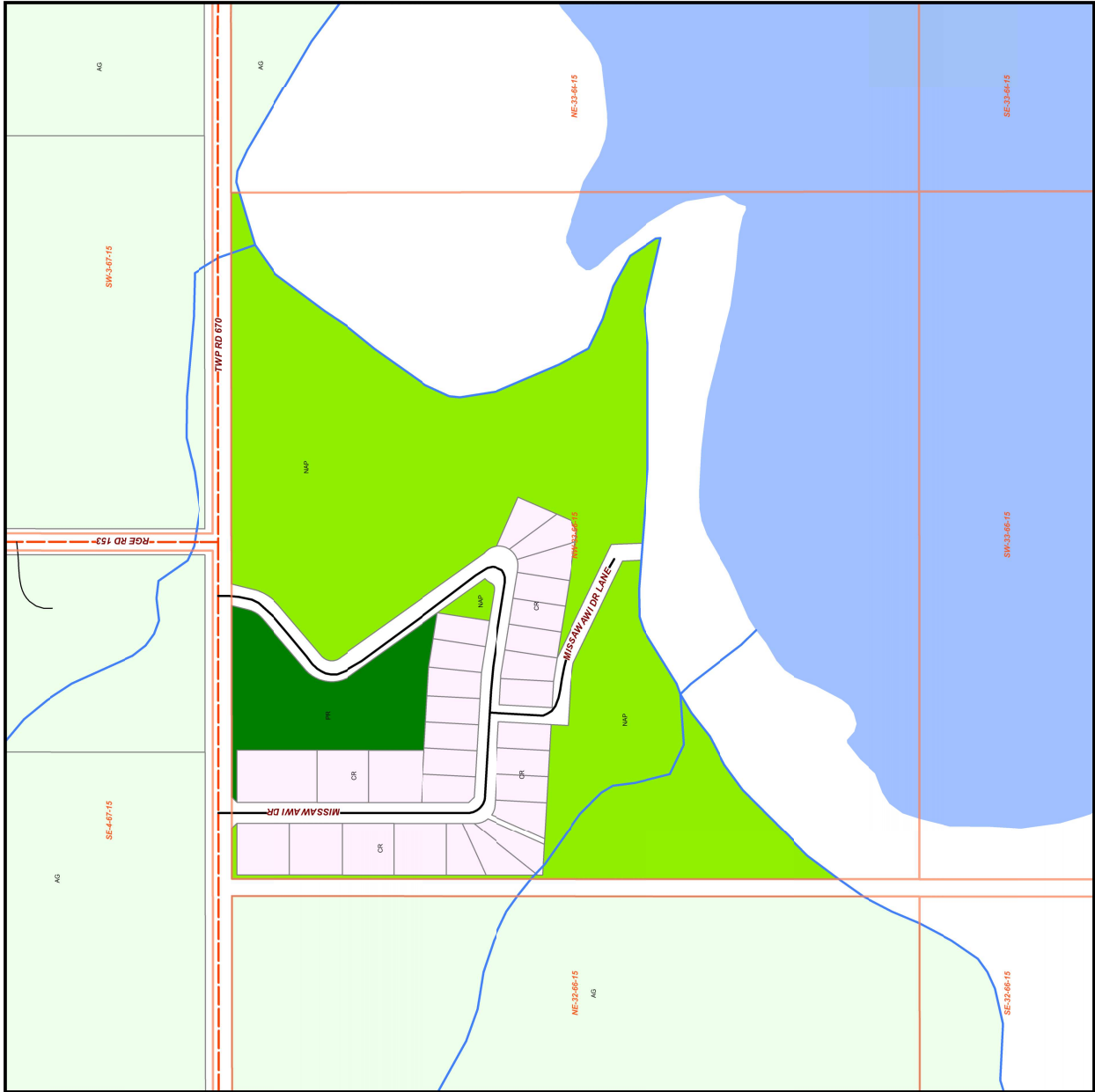

### RESIDENTIAL DISTRICTS

- Narrow Lot Single Detached Dwelling (NSD)
- Medium Density Hamlet Residential (MDR)
- Estate Small Lot Residential 1 (ES1)
- Country Residential (CR)
- Mobile Home Community (MHC)
- Resort Recreational (RR)
- Rural Residential Work/Live (RRW)
- Low Density Residential (LDR)
- High Density Hamlet Residential (HDR)
- Estate Small Lot Residential 2 (ES2)
- On-site Estate Residential 1 (OE1)
- On-site Estate Residential 2 (OE2)
- Restricted Residential Large Lot (RR)

### COMMERCIAL DISTRICTS

- Central Commercial (CC)
- Highway Commercial (HC)
- Neighbourhood Commercial (NC)
- Rural Commercial (RC)
- Mixed Use Residential - Business (MRB)
- Hamlet Commercial Business (HC-B)
- Urban Reserve (UR)
- Public Institutional (PI)
- Natural Area Protection (NAP)
- Parks and Recreation (PR)

### INDUSTRIAL DISTRICTS

- Light Industrial (LI)
- Hamlet Light Industrial (HLI)
- General Industrial (GI)
- Heavy Industrial (HI)
- Airport (A)

### DIRECT CONTROL DISTRICTS

- Direct Control 1 (DC1)
- Direct Control 2 (DC2)
- Direct Control 3 (DC3)

### RESOURCES DISTRICTS

- Agricultural (AG)
- Crown Land (CL)

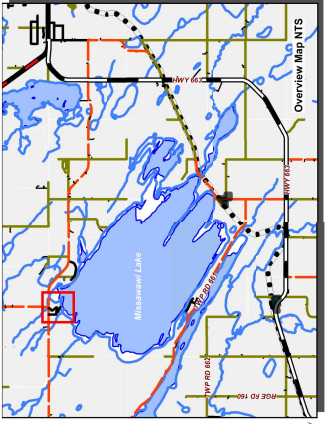

Scale 15,000

Map Sheet Updated: September 2017  
 Compiled from the Rural Cadastrial Digital Base May 2017  
 Shaded Data Warehouses Ltd.  
 All Rights Reserved.  
 Not to be copied in whole or in part.