

Bylaw 23-015

Schedule 'A'

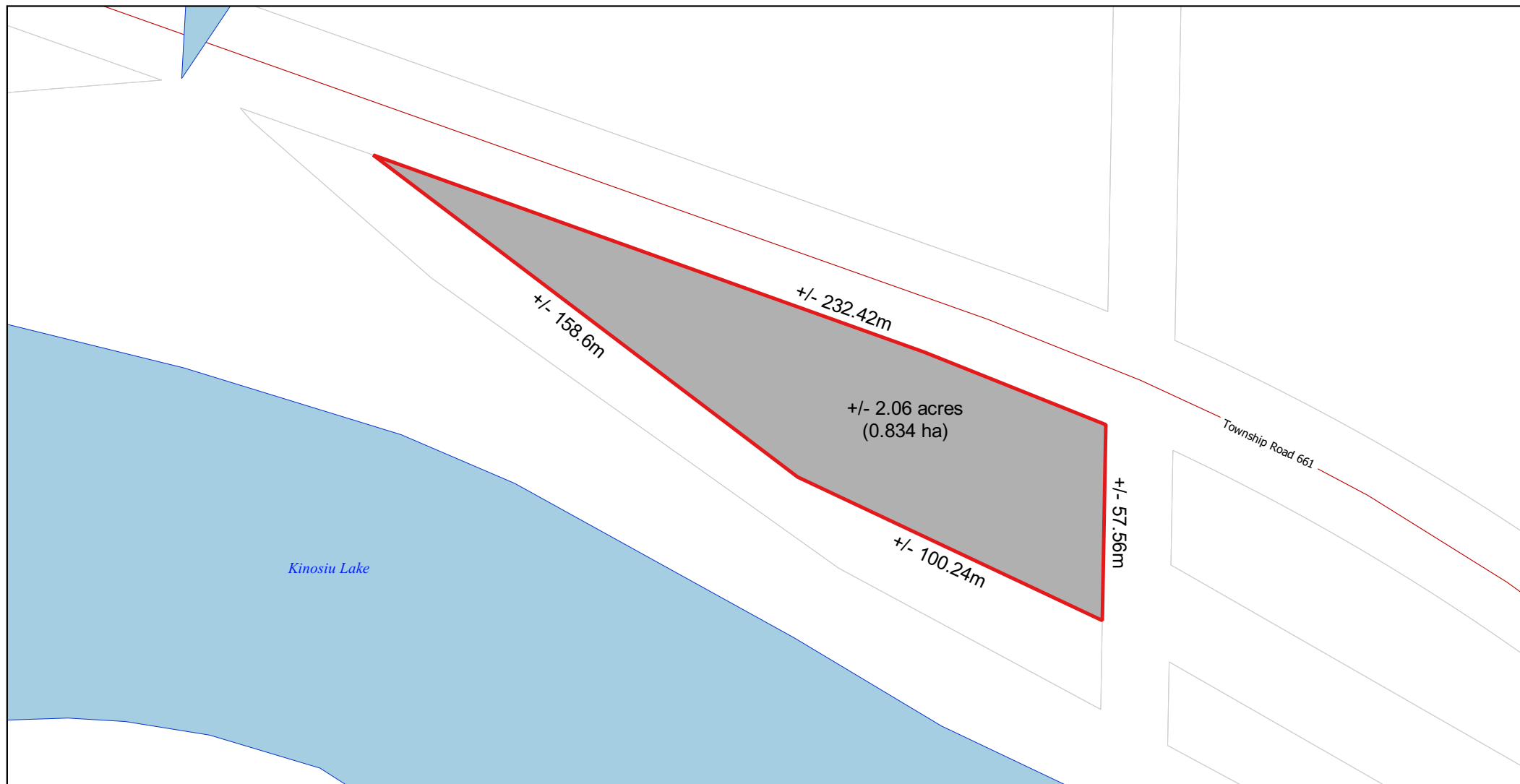

Map Produced: March 29, 2023

Projection: UTM12 NAD83



Subject Property

0 10 20 30 40 50 m



Lac La Biche County makes no representation or warranties regarding the information contained in this document, including, without limitation, whether said information is accurate or complete. Persons using this document do so solely at their own risk, and Lac La Biche County shall have no liability to such persons for any loss or damage whatsoever. This document shall not be copied or distributed to any person without the express written consent of Lac La Biche County.

Base Map compiled from the Provincial Title Mapping Digital Base.
Spatial Data Warehouse Ltd., November 2022. © 2023 Lac La Biche County. All Rights Reserved.