

- RESIDENTIAL DISTRICTS**
- Narrow Lot Single Detached Dwelling (NSD)
 - Medium Density Hamlet Residential (MDR)
 - Estate Small Lot Residential 1 (ES1)
 - Country Residential (CR)
 - Mobile Home Community (MHC)
 - Resort Recreational (RR)
 - Rural Residential Work/Live (RRW)
 - Low Density Residential (LDR)
 - High Density Hamlet Residential (HDR)
 - Estate Small Lot Residential 2 (ES2)
 - On-site Estate Residential 1 (OE1)
 - On-site Estate Residential 2 (OE2)
 - Restricted Residential Large Lot (RR)

- COMMERCIAL DISTRICTS**
- Central Commercial (CC)
 - Highway Commercial (HC)
 - Neighbourhood Commercial (NC)
 - Rural Commercial (RC)
 - Mixed Use Residential - Business (MREB)
 - Hamlet Commercial Business (HC-B)
 - Public Services Districts
 - Urban Reserve (UR)
 - Public Institutional (PI)
 - Natural Area Protection (NAP)
 - Parks and Recreation (PR)

- INDUSTRIAL DISTRICTS**
- Light Industrial (LI)
 - Hamlet Light Industrial (HLI)
 - General Industrial (GI)
 - Heavy Industrial (HI)
 - Airport (A)
- DIRECT CONTROL DISTRICTS**
- Direct Control 1 (DC1)
 - Direct Control 2 (DC2)
 - Direct Control 3 (DC3)

- RESOURCES DISTRICTS**
- Agricultural (AG)
 - Crown Land (CL)

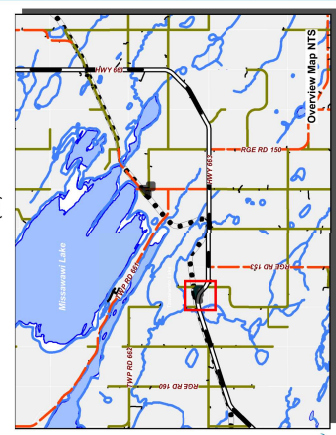
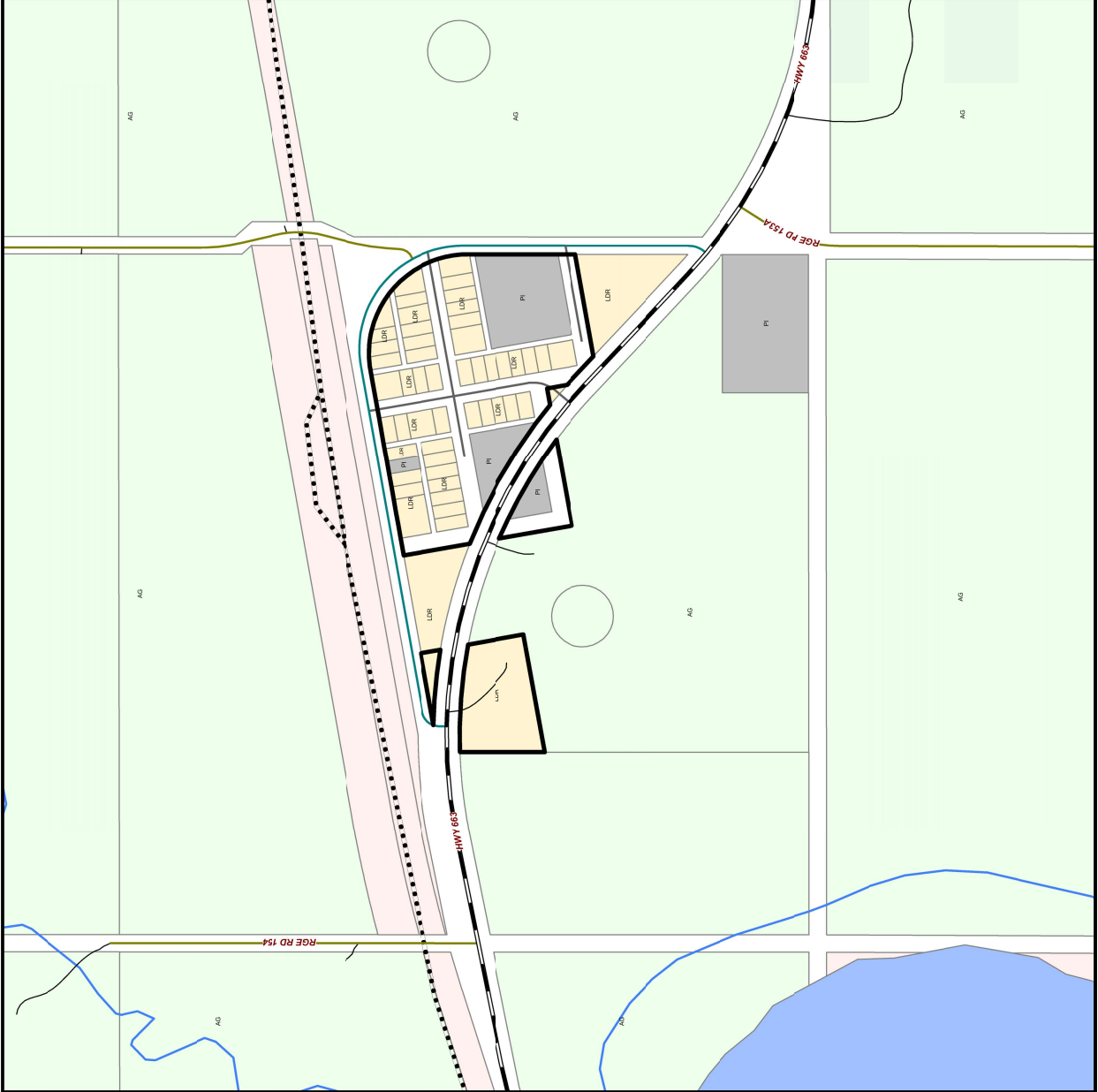

Map Sheet Updated: September 2017
 Compiled from the Rural Cadastral Digital Base May 2017
 Shaded Data Warehouses Ltd.
 All Rights Reserved.
 Not to be copied in whole or in part.